

Thank you for purchasing our equipment. Please read this manual carefully and heed the safety warnings and instructions before installing, using or repairing the equipment. This will ensure not only the protection of persons, but also the long life of the equipment.

SAFETY NOTICE





When using electrical appliances, basic safety precautions should always be observed to reduce the risk of fire, electric shock and personal injury, including the following. For your own safety and proper use, read the following information carefully before using the appliance for the first time.

- The device is not intended for children. It can only be used under adult supervision.
- If the power cord or the device is damaged, do not use the device. Repairs may only be carried out by the manufacturer's service centre.
- Prevent objects from entering the ventilation or exhaust opening. Do not cover any part of the equipment.
- Do not place the appliance directly under the socket.
- Do not use this device in the immediate vicinity of a bath, shower or swimming pool.
- Do not use the device if it is damaged.
- Use the device only on a stable, level surface.
- Do not use the device in rooms that are occupied by people who are unable to leave the room independently.
- Do not use the device near animals unless they are under constant supervision.
- To reduce the risk of fire, keep fabrics, curtains or any other combustible material at least 1m away from the air outlet.
- Some parts of this product can be very hot and cause burns.
- Do not use the device with an external timer or other external device that automatically turns it on or off.

- Always operate the equipment from a power source with the same voltage, frequency and rating as shown on the product identification label.
- Before use, remove the device from its packaging and check that it is in good condition.
- Be sure to turn off the power before disconnecting the power cord. Make sure to keep your hands dry when touching the unit to avoid electric shock.
- Before use, make sure the power cord is fully extended and positioned so that it does not touch any part of the heater.
- Some parts of the device are hot when in use. When carrying, hold the heater by the handle only.
- Do not use the device in areas such as garages where gasoline, paint or other flammable substances are used or stored.

- Place the device in a suitable location with a clear space of approximately 1 m on all sides.
- Do not place the cable under the carpet or cover it with carpet or furniture. Arrange the cable so that it cannot be tripped over.
- Do not expose the product (and its cable) to damp or wet environments.
- This product must not be used in the immediate vicinity of water such as a bathtub, sink, etc. where immersion or splashing may occur.
- A common cause of overheating is deposits of dust and fluff entering the heater. Ensure these deposits are removed regularly by unplugging the heater, allowing it to cool and cleaning it as described in the Maintenance section.
- Make sure that no other high-current appliances are connected to the same circuit as the heater, as overloading may occur.
- Do not use an extension cord as it may overheat and cause a fire hazard.
- The device can only be used indoors. Use of the equipment outdoors is strictly prohibited.
- When the device is switched on, do not leave it unattended.
- Do not place any objects on the equipment, do not allow objects to cover inlet or outlet openings, or work in close proximity to walls or curtains, etc. Do not cover the equipment during operation.
- Do not modify or repair the equipment in any way. Repairs may only be carried out by the manufacturer's service centre.

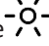
USE

1. Before inserting the plug into an electrical outlet, make sure that the electrical supply in your area matches the information on the unit's rating plate.
2. When plugged in, the ON/OFF symbol lights up on the display.
3. In standby mode, press the  button to start the device.
 - a. The default heating mode is High Heat, the  symbol will light up and the unit will heat continuously in High Heat.
 - b. ECO mode (press the MODE button to switch it, the ECO symbol will light up), the device will operate in economy mode.
 - c. Fan mode (press the MODE button again to switch it), the  symbol lights up.
 - d. Low heat mode (press MODE again to switch, the  symbol will light up), the heater will heat continuously at low power.
 - e. Timer
Press the TIMER button repeatedly to set the time after which the device will turn itself off (from 0 hours to 9 hours, in 1 hour intervals).
 - f. Child lock function
Hold down the TIMER button for 3 seconds. The device control will be locked and the lock symbol will light up on the display. To cancel the lock, hold the TIMER button again for 3 seconds.
 - g. Room temperature setting:
Can be set between 15°C ~ 35°C. The default temperature setting is 30°C. Press the temperature setting button to set the desired temperature. In this smart mode, the temperature setting button and MODE will light up and the unit will now automatically turn on and off to maintain the set room temperature.
 - h. Light markings: there are three lights on the top control cover, blue for fan mode, purple for low heating power, red for high heating power and ECO mode, you can turn off the lights with the remote control.
 - i. ECO mode
The red light will flash slowly and the ECO symbol will appear. The appliance will heat in a High Heat - Low heat cycle to maintain a room temperature of around 24°C. The device will automatically switch off if there is no change in the settings on the device during 24 hours of continuous operation.
 - j. To turn the device rotation on/off, press the Rotation button.
 - k. Press the  button to turn off the device. The device will run in fan mode for the next 15 seconds to cool down, then shut down.

Note: Holding the  button for 3 seconds will turn the display off, pressing any button will turn it back on.

DISPLAY DESCRIPTION

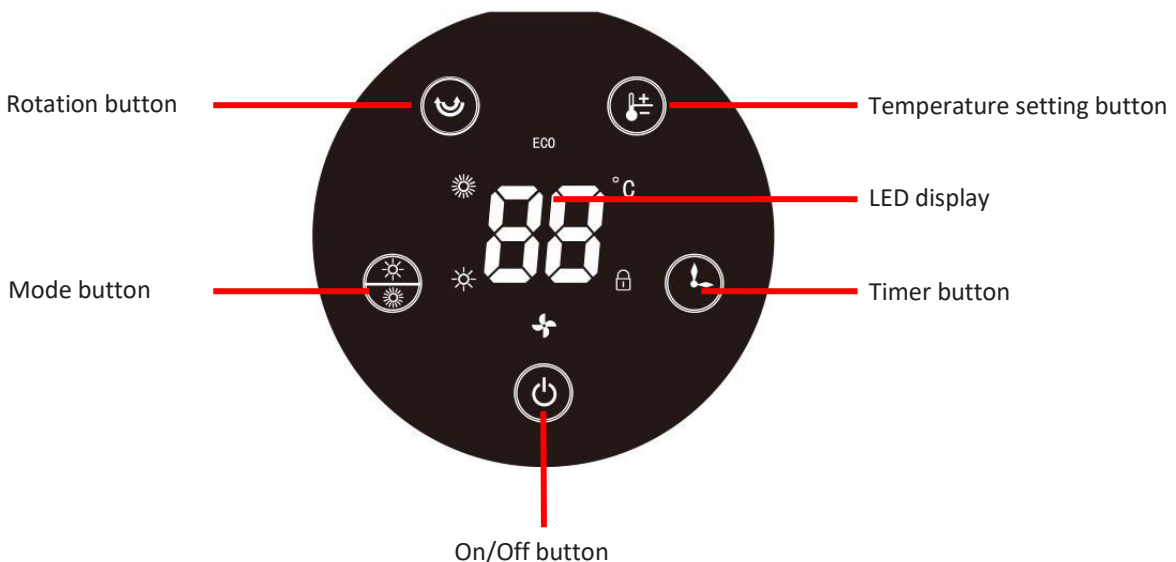

REMOTE CONTROL

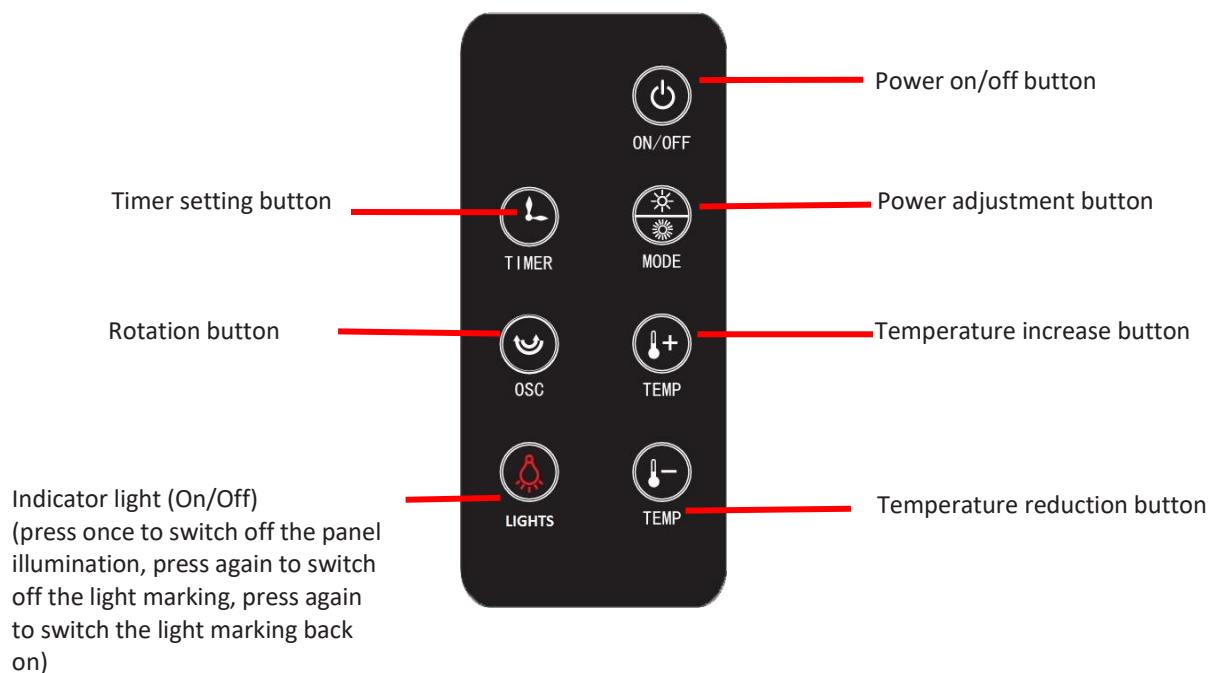

OVERHEATING PROTECTION

The appliance is protected by overheating protection, which automatically switches the appliance off in the event of overheating, e.g. due to complete or partial blockage of the grilles. In this case, unplug the appliance from the socket, wait about 30 minutes for it to cool down. Remove any objects that obstruct the grids. Then switch it on again as described above.

NOTE: When you press the Off button, the power button is turned off. The fan will continue to blow air for 15 seconds and then go into standby mode.

SAFETY MEASURES

- In the event of abnormal overheating, the safety fuse automatically switches off the appliance. In this case, the heater must be unplugged from the socket, after a short cooling phase the appliance is ready for use again.
- If you still observe the same fault as above, remove the plug from the socket and claim the device.
- Do not touch or cover the air outlet during use. This could cause the unit to overheat and activate the safety mode.
- The device is also equipped with an anti-tip switch that automatically switches off the power supply in the event of a tip-over.

Note: This device uses a built-in switch that will only turn off the heater if it tips over.

MAINTENANCE

Your appliance must be switched off and unplugged before cleaning.

- Clean the cover with a lightly dampened cloth, vacuum cleaner or dusting brush.
- Never use flammable or abrasive cleaning agents such as benzene or rubbing alcohol to clean the appliance.
- Never immerse the device in water.
- Regularly clean the air inlet and outlet with a vacuum cleaner.
- If you are not going to use the device for a long period of time, you need to protect it from excessive dust and dirt.
- Store the device in a dry place away from sunlight.

TECHNICAL PARAMETERS

- Power: 2000 W
- Voltage: 220 - 240 V ~, 50-60Hz
- Protection: IPX0
- : Class II



The product has been issued with a CE declaration of conformity in accordance with the applicable regulations. On request from the manufacturer: info@solight.cz, or downloadable from www.solight.cz/en.

SOLIGHT

Solight Holding, s.r.o., Na Brně 1972, Hradec Králové 500 06, Czech Republic.